

# BATTLEFIELD INTERNATIONAL ISO 6431 CYLINDER

# SERIES TS-TM

BORE SIZES	STANDARD MATERIALS	TEMPERATURE RANGE	PRESSURE RANGE
32 mm 40 mm 50 mm 63 mm 80 mm 100 mm	CAPS: machined and anodized aluminum TUBE: extruded and anodized aluminum ROD: X20 Cr13 stainless steel ROD BEARING: bronze, self lubricating SEALS: NBR, 70 shore MOUNTING SCREWS: steel zinc or nickel plated	-20C....+80C	1-10 bar



Series TS and TM are constructed with clean profile aluminum. The caps are machined not die cast, and are well suited to the food industry or areas requiring wash down. We make these cylinders right here, usually the same day our customers order them, and specials are no-problem. We do not list any standard strokes as any stroke is easily produced from 1mm to 2000mm.

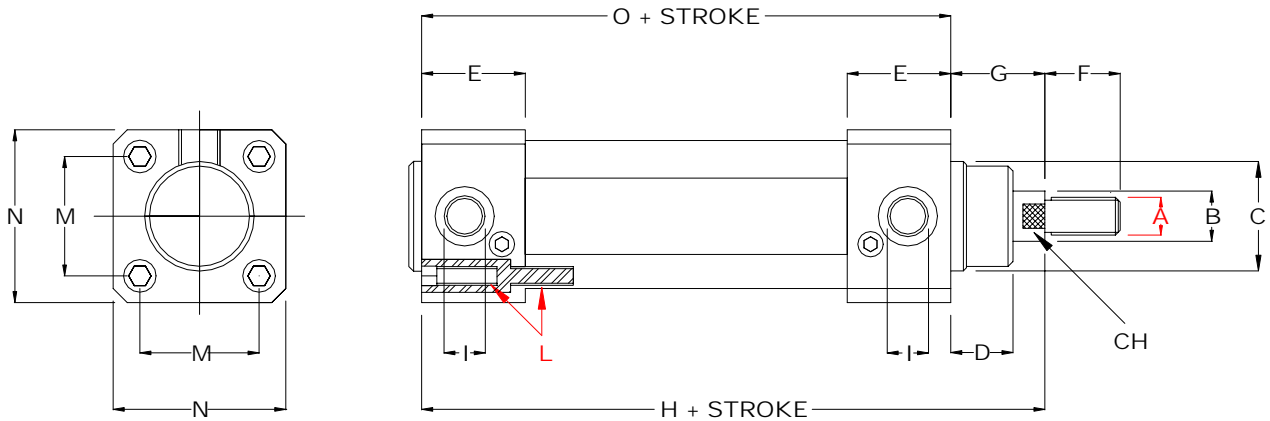

CYL DIA (mm)	Part Number With Standard Piston	Part Number With Magnetic Piston	A	B	C	D	E	F	G	H	I	L	M	N	O	CH
32	TS-32-stroke in mm	TM-32-stroke in mm	M10 X 1.25	12	30	16	32	22	26	120	1/8	M6	32.5	45	94	10
40	TS-40-stroke in mm	TM-40-stroke in mm	M12 X 1.25	16	35	20	33	24	30	135	1/4	M6	38	55	105	14
50	TS-50-stroke in mm	TM-50-stroke in mm	M16 X 1.5	18	40	25	34	32	37	143	1/4	M8	46.5	65	106	17
63	TS-63-stroke in mm	TM-63-stroke in mm	M16 X 1.5	20	45	25	39	32	37	158	3/8	M8	56.5	75	121	17
80	TS-80-stroke in mm	TM-80-stroke in mm	M20 X 1.5	25	45	33	38.5	40	46	174	3/8	M10	72	95	128	22
100	TS-100-stroke in mm	TM-100-stroke in mm	M20 X 1.5	25	55	37	45	40	51	189	1/2	M10	89	115	138	22