

## LOGIC VALVES ANTI TIE DOWN

## BATTLEFIELD INTERNATIONAL PNEUMATIC VALVES

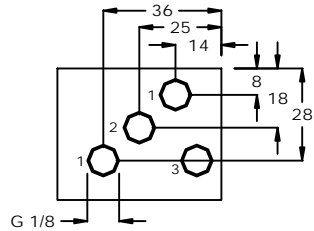

V0232ATD Valves are Anti-Tie down valves which, when connected to two 3 way manual valves, ensure that both manual valves must be operated each time simultaneously before a signal will get through this logic element. The purpose of this valve is to ensure operator safety by ensuring both hands must be on the valves and away from machinery. Our logic valves are made from machined and anodized aluminum. Temperature range is -20C.....+80C. Pressure range is 1....10 bar .



| Part Number | Description               |
|-------------|---------------------------|
| V0232ATD    | 1/8" Anti Tie Down Module |

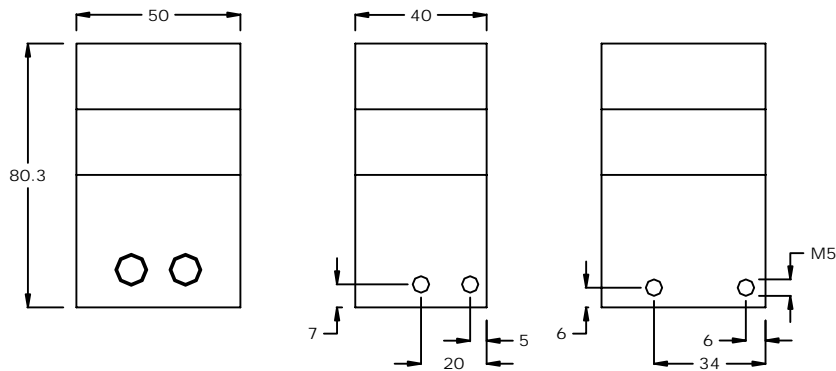

## LOGIC VALVES OR (shuttle) and NOT elements



Series OR valves are used to enable two different 3 way valves to connect to the same pilot port. Series L01 NOT valves enable cylinder location detection without the need for limit valves. Our logic valves are made from machined and anodized aluminum. Temperature range is -20C.....+80C. Pressure range is 1....10 bar .

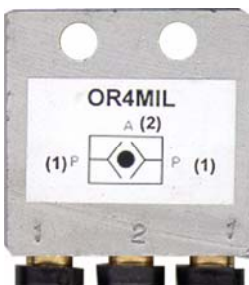

| Part Number | Description                         |
|-------------|-------------------------------------|
| OR02        | 1/8" "OR" Shuttle Valve             |
| OR4MIL      | 4mm Push Connect "OR" Shuttle Valve |
| L01NOT      | 4mm Push Connect "NOT" Logic Valve  |